

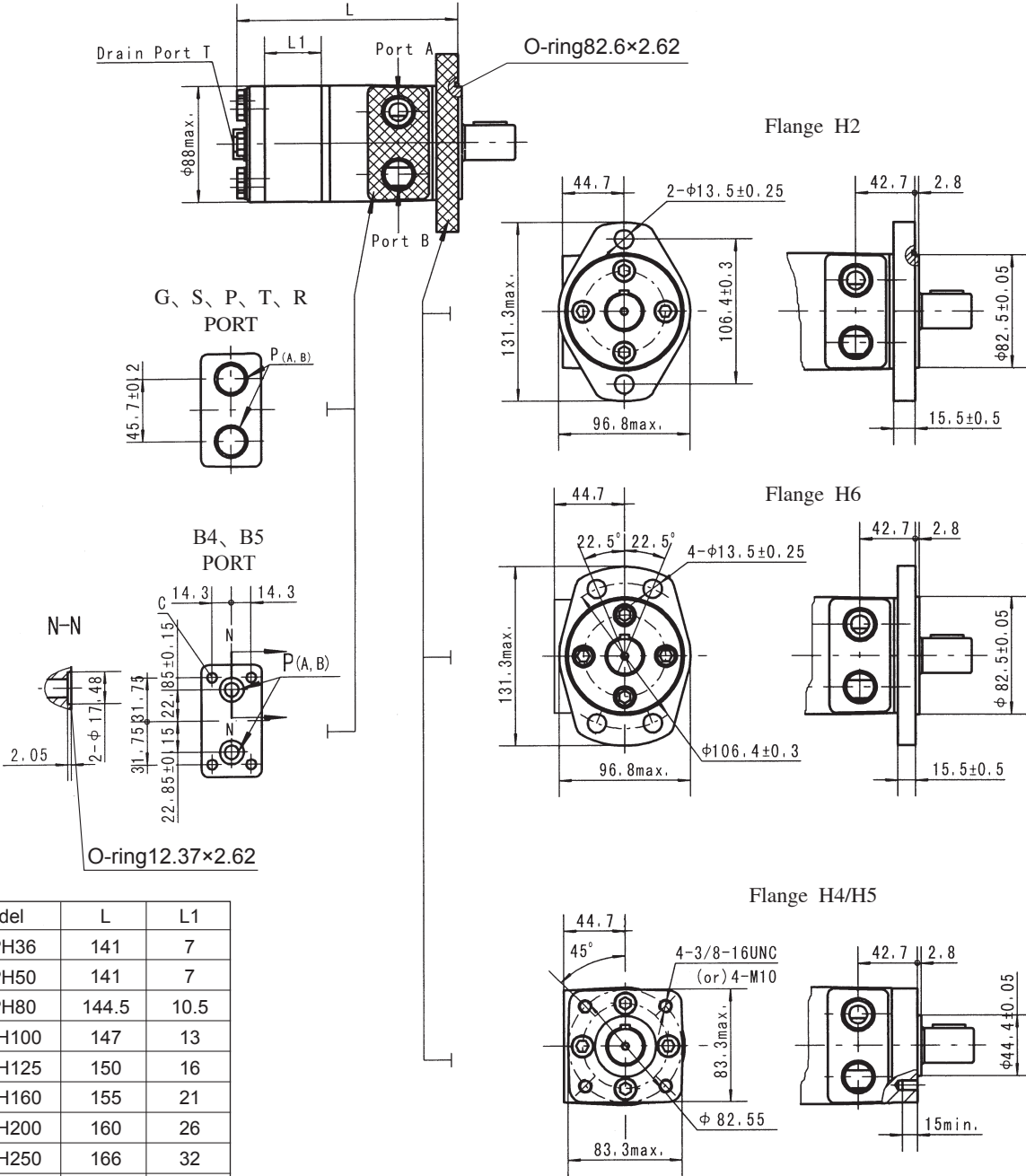

BMPH DIMENSIONS AND MOUNTING DATA

MOUNTING



Model	L	L1
BMPH36	141	7
BMPH50	141	7
BMPH80	144.5	10.5
BMPH100	147	13
BMPH125	150	16
BMPH160	155	21
BMPH200	160	26
BMPH250	166	32
BMPH315	176	42
BMPH400	186	52
BMPH500	199	65

Note: The size L of the BMPH N1 should be increased by 2mm.

Code	G (depth)	S (depth)	P (depth)	T (depth)	R (depth)	B4 (depth)	B5 (depth)
P(A,B)	G1/2 (15)	7/8-14 O-ring (17)	1/2-14NPTF (15)	3/4-16 O-ring (15)	PT(RC)1/2 (15)	ø10	ø10
T	G1/4 (12)	7/16-20UNF (12)	7/16-20UNF (12)	7/16-20UNF(12)	PT(RC)1/4 (9.7)	7/16-20UNF(12)	G1/4(12)
C	-	-	-	-	-	4-5/16-18UNC(13)	4-M8(13)

BMP SHAFT EXTENSIONS DIMENSIONS DATA

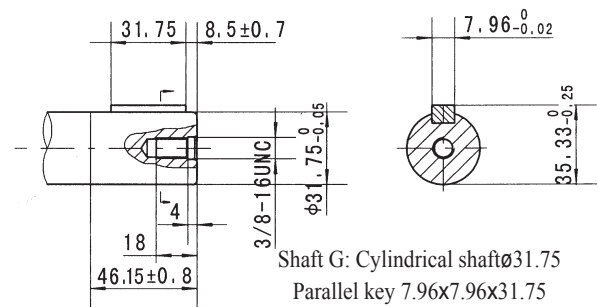
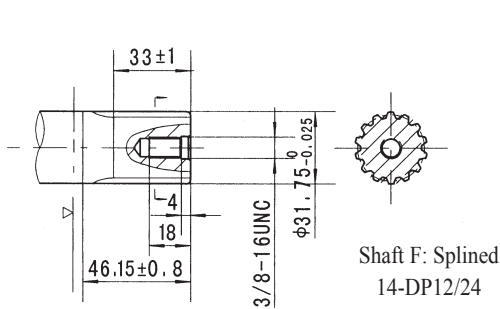
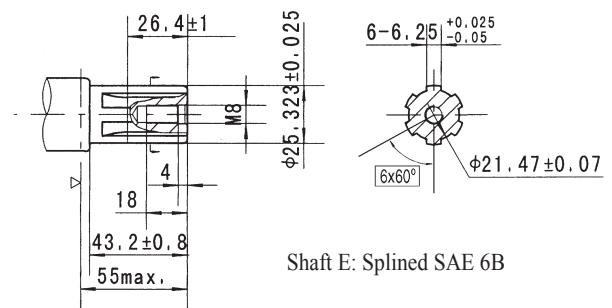
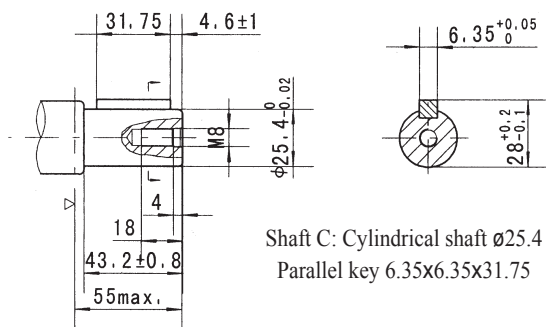
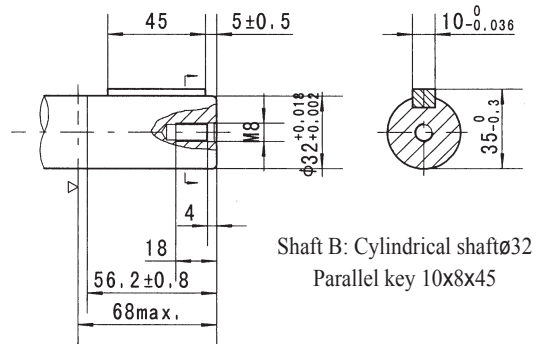
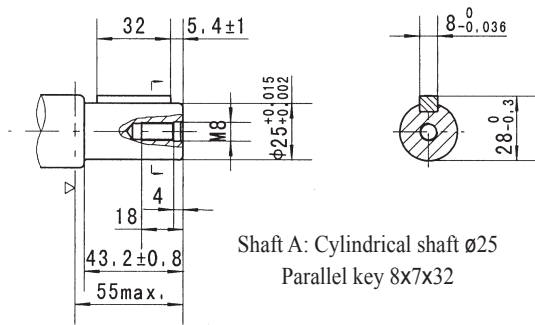

▷ Motor Mounting Surface

BMP SHAFT EXTENSIONS DIMENSIONS DATA

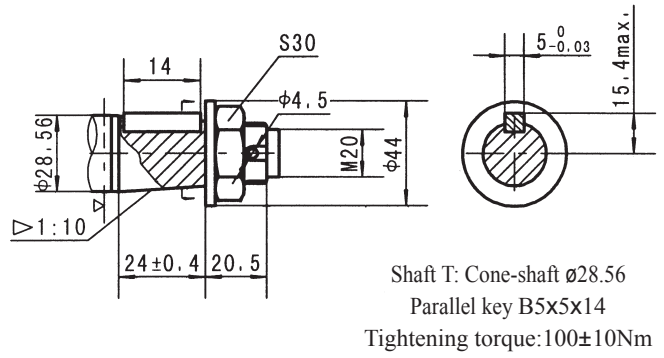
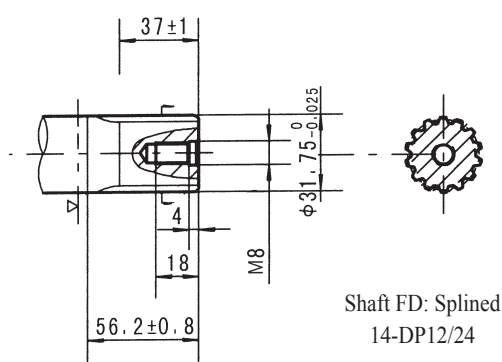
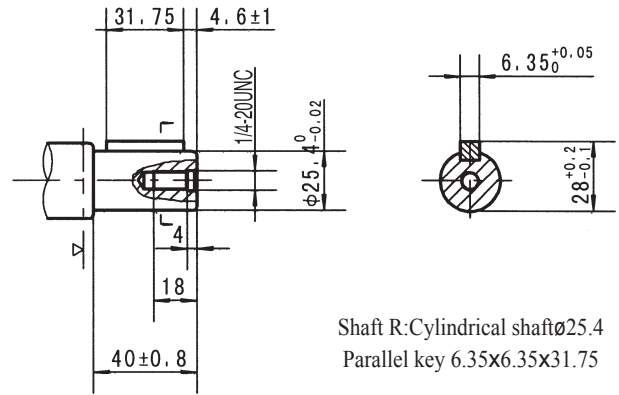
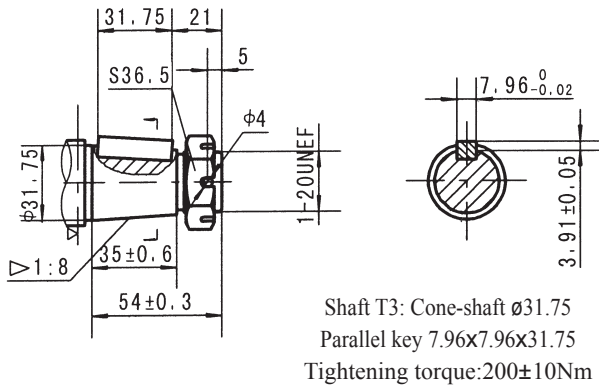

▷ Motor Mounting Surface

BMPH SHAFT EXTENSIONS DIMENSIONS DATA

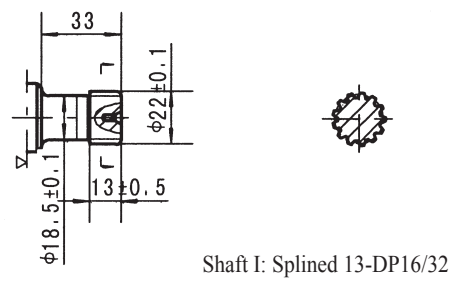
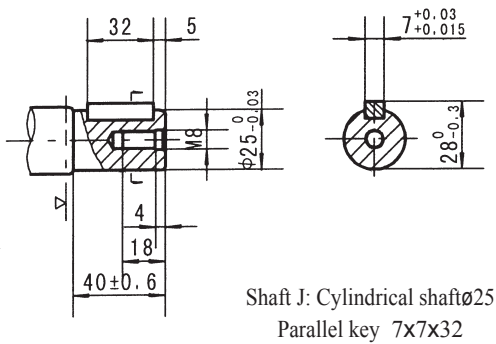
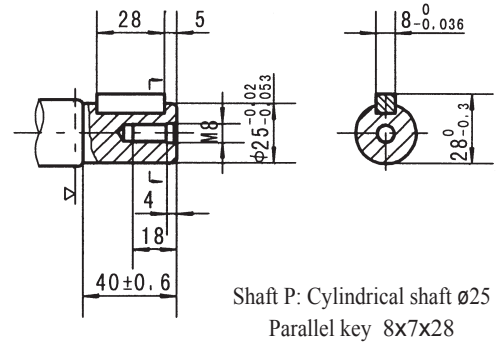
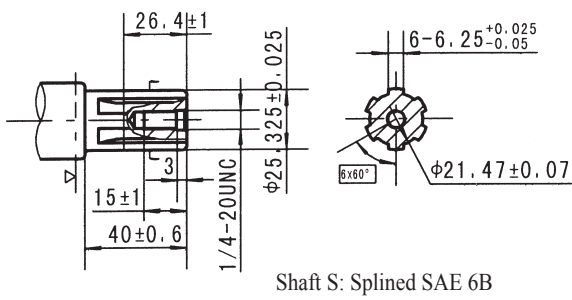
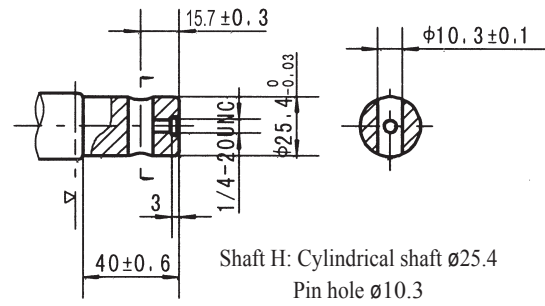
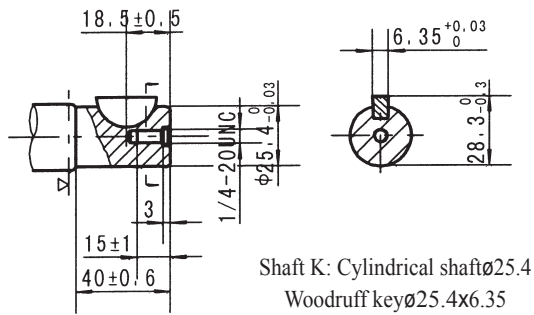

▷ Motor Mounting Surface

BMPH SHAFT EXTENSIONS DIMENSIONS DATA

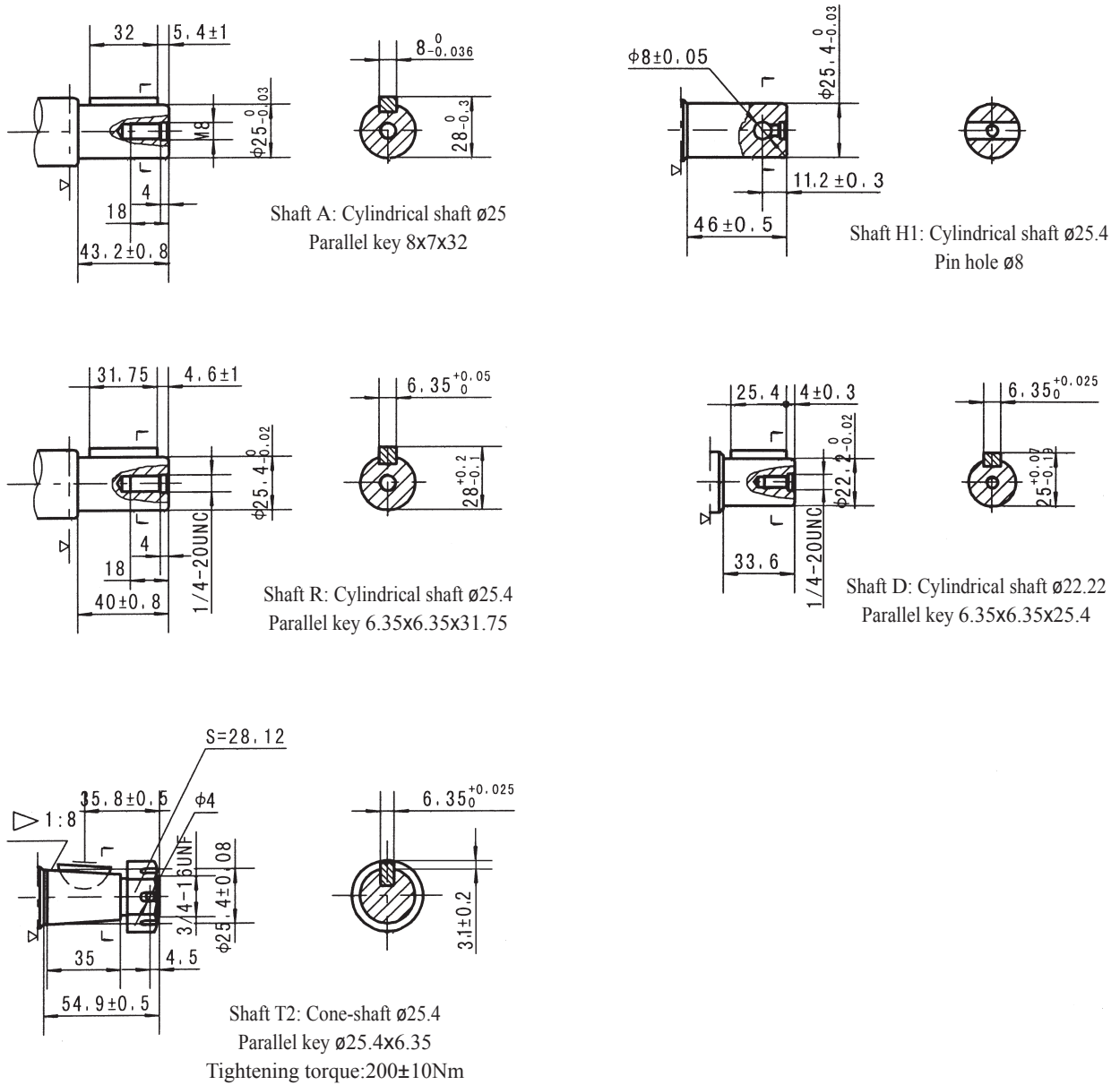

▷ Motor Mounting Surface

BMP、BMPH Series Hydraulic Motor

Permissible shaft seal pressure

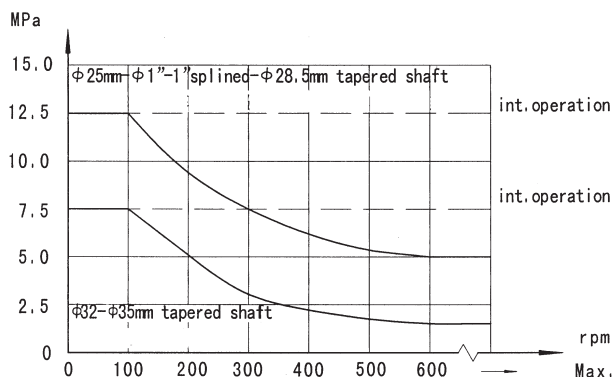
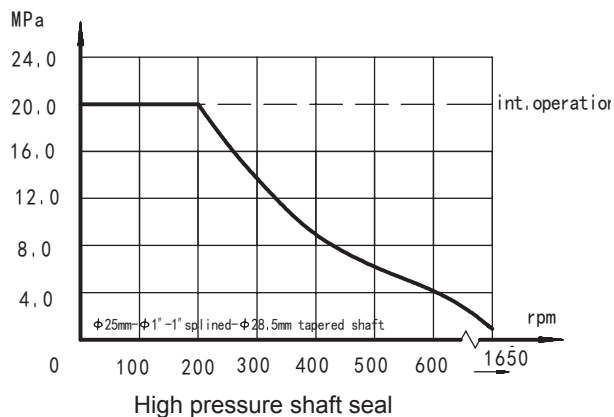
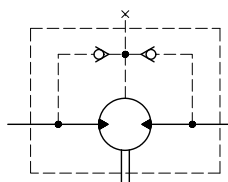

In applications without drain line, output shaft seal exceeds a bit of the pressure in the return line. When applications use the drain line, the pressure of output shaft seal equals the pressure in drain line.

Direction of shaft rotation: Standard

When facing shaft end of motor, shaft to rotate:
Clockwise when port "A" is pressurized.
Counter-clockwise when port "B" is pressurized.

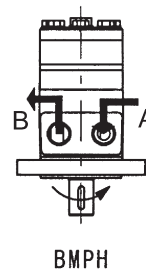
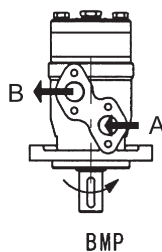

Status of the shaft's radial force (Standard motor with journal bearing)

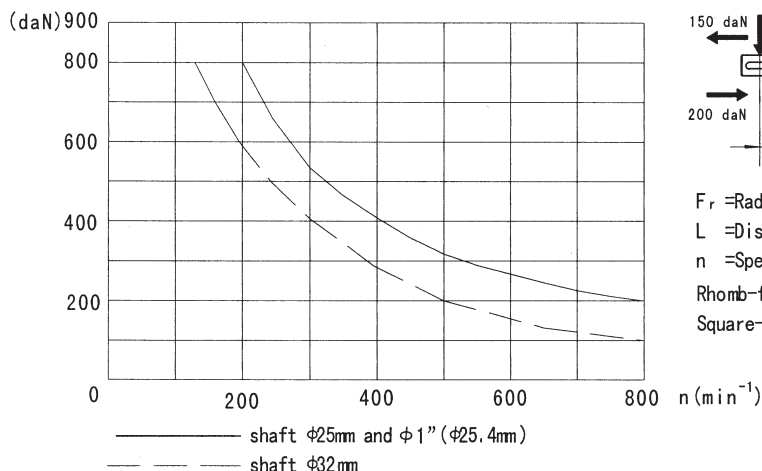

$$F_r = \frac{800 \cdot 25000}{n \cdot 95 + L} \text{ daN}$$

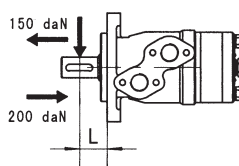

F_r =Radial Force (.daN)
 L =Distance (mm)
 n =Speed (rpm)
Rhomb-flange $L=30\text{mm}$
Square-flange $L=24\text{mm}$

Oil flow in drain line

The table shows the Max. oil flow in the drain line at a return pressure less than 0.5-1MPa.

Pressure drop (MPa)	Viscosity (mm ² /s)	Oil flow in the drain line (L/min.)
10	20	2.5
	35	1.8
14	20	3.5
	35	2.8



Order Information



Pos.1	2	3	4	5	6	7	8
Code	Disp.	Flange	Output Shaft	Ports and Drain Port	Rotation Direction	Paint	Unusually Function
BMP	36	2-Ø13.5 Rhomb-flange , pilot Ø82.5x8	A Shaft Ø25,parallel key 8x7x32	G1/2 Manifold Mount 4xM8, G1/4 M22x1.5 Manifold Mount 4xM8, M14x1.5 7/8-14 O-ring manifold 4x5/16-18UNC, 7/16-20UNF 1/2-14 NPTF Manifold 4x5/16-18UNC, 7/16-20UNF PT(Rc)1/2 Manifold 4xM8, PT(Rc)1/4	Standard Opposite	No paint Blue Black Silver grey	Standard Big radial force No case drain Free Running Low Speed
	50		C Shaft Ø25.4,parallel key 6.35x6.35x31.75				
	80	E Shaft Ø25.4,splined tooth SEA 6B					
	100	R Short shaft Ø25.4,parallel key 6.35x6.35x31.75					
	125	T Cone shaft Ø28.56,parallel key B5x5x14					
	160	H4 4-3/8-16 Square-flange , pilot Ø44.4x2.8	B Shaft Ø32,parallel key 10x8x45				
	200	H5 4-M10 Square-flange , pilot Ø44.4x2.8	F Shaft Ø31.75,splined tooth 14-DP12/24				
	250		FD Long shaft Ø31.75,splined tooth14-DP12/24				
	315		G Shaft Ø31.75, parallel key 7.96x7.96x31.75				
	400		T3 Cone shaft Ø31.75,parallel key 7.96x7.96x25.4				
500							

Note:The shafts of B\F\FD\G\T\T3 are only suitable for flanges of 2 and 4.



Pos.1	2	3	4	5	6	7	8	
Code	Disp.	Flange	Output Shaft	Ports and Drain Port	Rotation Direction	Paint	Unusually Function	
BMPH	36	2-Ø13.5 Rhomb-flange , pilot Ø82.5x2.8	K Shaft Ø25.4, woodruff key Ø25.4x6.35	G1/2, G1/4 7/8-14 O-ring, 7/16-20UNF 1/2-14 NPTF, 7/16-20UNF 3/4-16 O-ring, 7/16-20UNF PT(Rc)1/2, PT(Rc)1/4 Ø10 O-ring manifold 4x5/16-18UNC,7/16-20UNF Ø10 O-ring manifold 4xM8, 7/16-20UNF	Standard Opposite	No paint Blue Black Silver grey	Standard Big radial force No case drain Free Running Low Speed	
	50		S Shaft Ø25.4, splined tooth SEA 6B					
	80		A Shaft Ø25.4, parallel key 8x7x32					
	100		R Shaft Ø25.4, parallel key 6.35x6.35x31.75					
	125		H 4-Ø13.5 Rhomb-flange , pilot Ø82.5x2.8					H Shaft Ø25.4, pin hole Ø10.3
	160		H4 4-3/8-16 Square-flange , pilot Ø44.4x2.8					H1 Shaft Ø25.4, pin hole Ø8
	200		H5 4-M10 Square-flange , pilot Ø44.4x2.8					D Shaft Ø22.22, parallel key 6.35x6.35x25.4
	250							I Shaft Ø22.22, splined tooth 13-DP16/32
	315							T2 Cone shaft Ø25.4, woodruff key Ø25.4x6.35
	400							P Shaft Ø25, parallel key 8x7x28
500		J Shaft Ø25, parallel key 7x7x32						

Note:When the table is used, please fill the code of left rows in dash area and give us, which the code information is consists of construction, displacement, mounting flange, output shaft and ports. If the specification is not in the table or you have specific requirements, please contact us.

专业做液压-专注做精品

PROFESSIONAL ON HYDRAULIC- FOCUS ON HIGH QUALITY

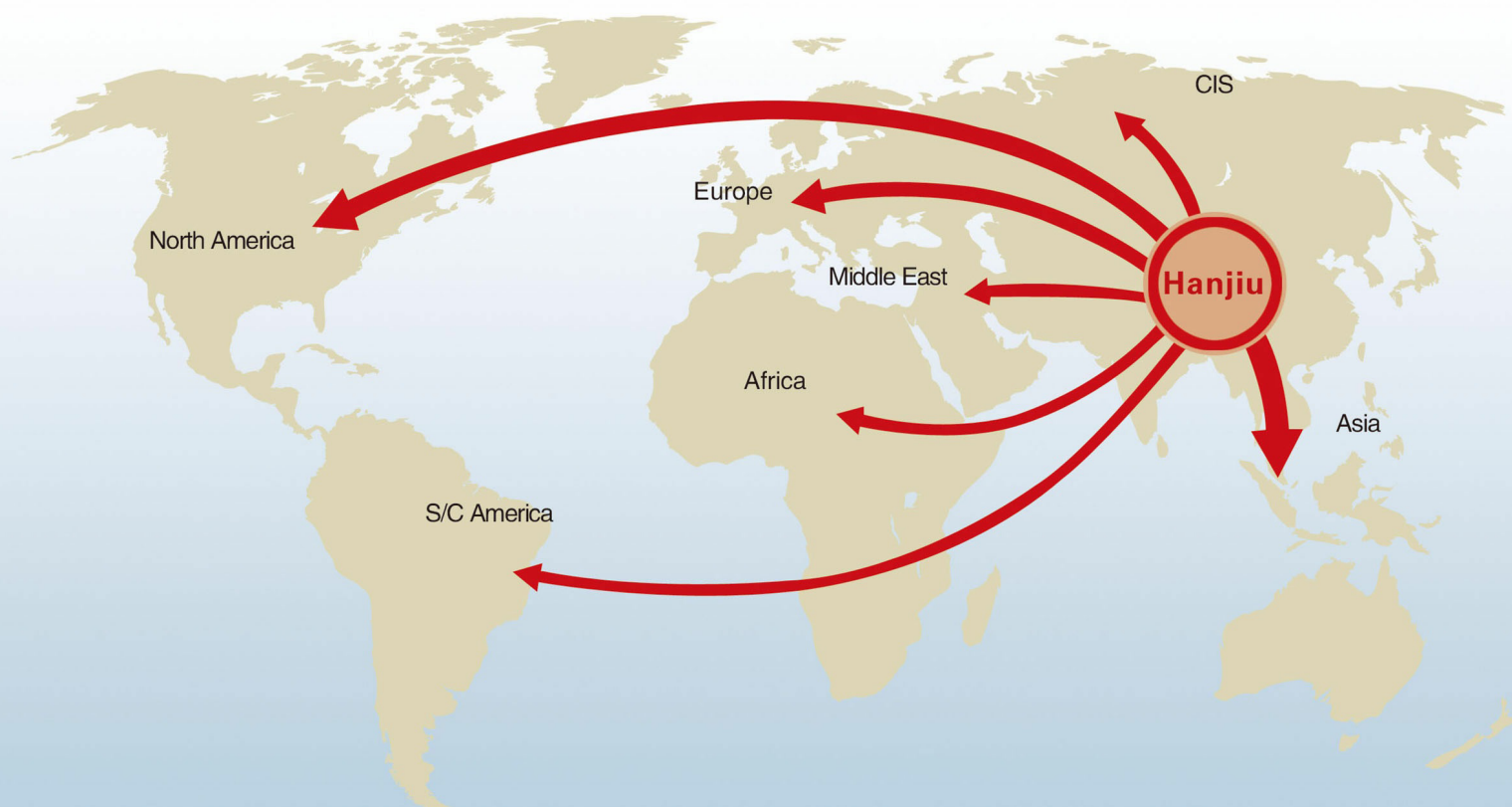

石家庄寒九科技有限公司

地址：中国河北石家庄友谊北大街398号

电话：+86 (311) 68123061

传真：+86 (10) - 80115555-568844

邮编：050000

网址：www.hjhydraulic.com

邮箱：manager@sjzhjism.com

SHIJIAZHUANG HANJIU TECHNOLOGY CO.,LTD.

Add: No. 398 Youyi Street, Shijiazhuang, Hebei, China

Tel: +86 (311) 68123061

Fax: +86 (10) - 80115555-568844

Post code: 050000

Web: www.hjhydraulic.com

Email: manager@sjzhjism.com